



**LOBKOWICZ**

LOBKOWICZ EVENTS MANAGEMENT

# LOBKOWICZ PALACE

at Prague Castle

# LOBKOWICZ PALACE AT PRAGUE CASTLE

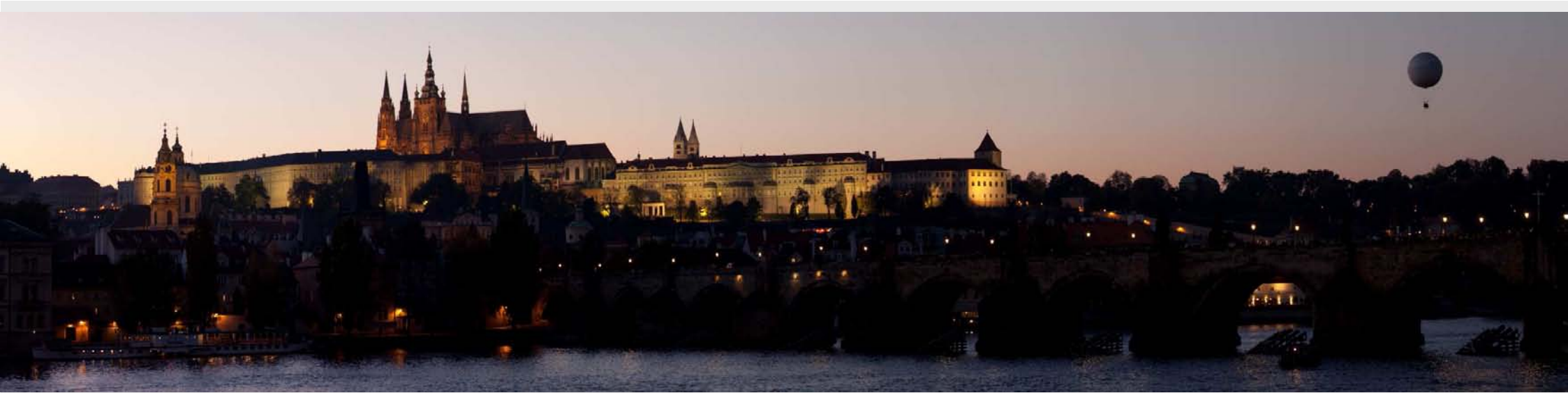

Hold your next event at historic Lobkovicz Palace, where luxurious spaces, museum collections of worldwide significance and stunning views across the city of Prague combine to create a memorable experience in a rich and distinctive setting.

# HISTORY OF LOBKOWICZ PALACE

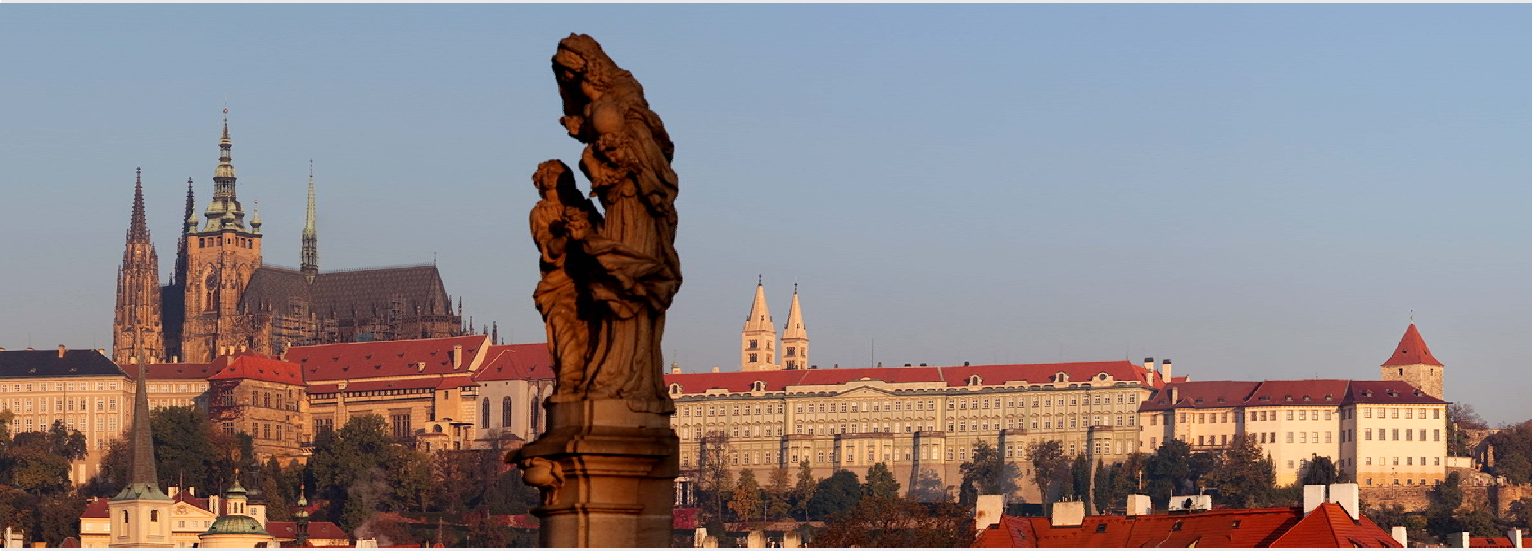

Lobkowitz Palace was built in the second half of the 16th century by Czech nobleman Jaroslav of Pernštejn (1528-1569). Originally known as the Pernštejn Palace, it acquired its present name when Jaroslav's niece, Polyxena (1566-1642), married the 1st Prince Lobkowitz, Zdeněk Vojtěch (1568-1628), in 1603. In the centuries following that marriage, the Palace witnessed some of Bohemia's most significant historical events.

At the start of World War II, the Palace was confiscated from the Lobkowitz family by the Nazi forces invading Czechoslovakia. Returned in 1945, it was seized again following the communist takeover of the country in 1948. After the Velvet Revolution of 1989 and the subsequent fall of the communist government, the passage of restitution laws made it possible in 2002 for the Palace to be returned to the Lobkowitzes once again.

On 2 April 2007, following more than four years of planning, restoration and refurbishment, the Palace was opened to the public for the first time. Today, it houses the Lobkowitz Palace Museum and serves as a unique venue for private and corporate events.

# THE LOBKOWICZ COLLECTIONS



The River Thames with St. Paul's Cathedral on Lord Mayor's Day  
Antonio Canaletto, c. 1748



Haymaking  
Pieter Brueghel the Elder, c. 1565

The Lobkowitz Collections is the oldest largest private art collection in the Czech Republic. Highlights from The Collections include world-famous paintings by three Brueghels, Canaletto, Cranach, Rubens and Veronese; decorative arts from the medieval, Renaissance and Baroque periods; ceramics from the 16th through the 20th centuries; exceptional arms and armor; musical instruments, musical scores and autograph manuscripts by many of the greatest composers of the 17th, 18th and 19th centuries, including Beethoven and Mozart; a comprehensive historical archive and one of the finest private libraries in Central Europe.

Confiscated from the Lobkowitz family twice in the 20th century – first by the Nazis at the start of World War II and then by the communist government in 1948 – The Collections remained out of the family's possession for nearly forty years. Returned to the Lobkowitzes following the passage of restitution laws in the early 1990s, The Collections is today housed in part at the Lobkowitz Palace Museum, which is open to the public.

# LOBKOWICZ PALACE – AS A VENUE



PANORAMIC VIEW OF PRAGUE



- |                       |                              |
|-----------------------|------------------------------|
| 1a - Concert Hall     | 6 - Oriental Room            |
| 1b - Family Chapel    | 7 - Piranesi Room            |
| 2a - Balcony Room     | 8 - Dog Room                 |
| 2b - Terrace          | 9 - Bird Room                |
| 3 - Rococo Room       | 10 - Princess Ernestine Room |
| 4 - Music Salon       | 11 - Imperial Hall           |
| 5 - Prince Moric Room | 12 - Prince Ferdinand Room   |

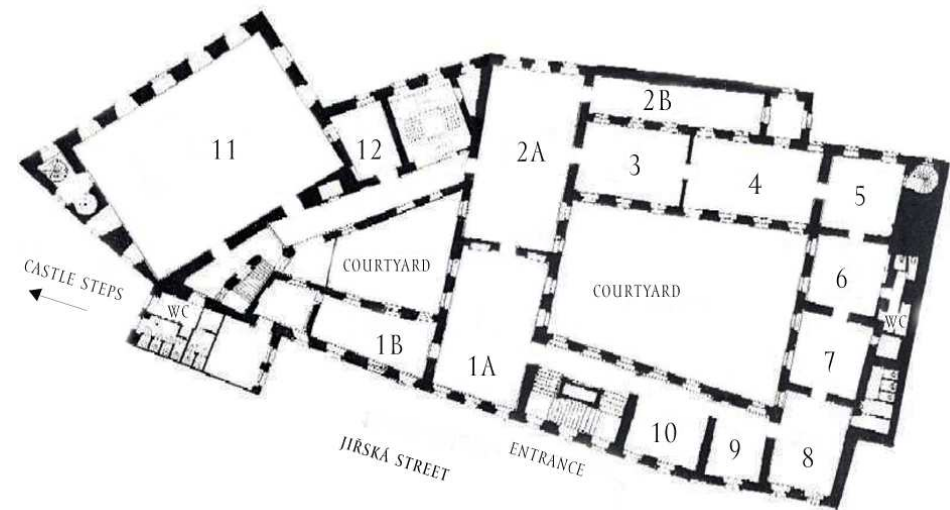

# LOBKOWICZ PALACE – AS A VENUE

ROOM	ROOM SIZE	AREA SQ. METERS	BANQUET CAPACITY	BUFFET CAPACITY	COCKTAIL CAPACITY	THEATER CAPACITY
1a - Concert Hall	12 x 8	96	70	100	120	120
2a - Balcony Room	15 x 8	120	80	120	150	140
2b - Terrace	10,5 x 3,5	36,75	-	-	80	-
3 - Rococo Room	8,7 x 6	52,2	30	30	30	30
4 - Music Salon	10 x 6	60	40	40	40	50
5 - Prince Moric Room	6,3 x 5	31,5	20	-	20	-
6 - Oriental Room	5,2 x 6	31,2	20	-	20	-
7 - Piranesi Room	5,8 x 6	34,8	20	-	20	-
8 - Dog Room	6 x 7,8	46,8	30	-	20	-
9 - Bird Room	6 x 4,5	27	10	-	15	-
10 - Princess Ernestine Room	6 x 6,5	39	20	-	20	-
11 - Imperial Hall	18 x 13	234	180	220	350	300
12 - Prince Ferdinand Room	5,7 x 4,1	23,37	12	-	15	-

1a - Concert Hall



# LOBKOWICZ PALACE – AS A VENUE

2a - Balcony Room



2b - Terrace



3 - Rococo Room



# LOBKOWICZ PALACE – AS A VENUE

4 - Music Salon



5 - Prince Moric Room



6 - Oriental Room





# LOBKOWICZ PALACE – AS A VENUE

7 - Piranesi Room



8 - Dog Room



9 - Bird Room



# LOBKOWICZ PALACE – AS A VENUE

10 - Princess Ernestine Room



11 - Imperial Hall



12 - Prince Ferdinand Room



# LOBKOWICZ PALACE – LOCATION



VIEW OF PRAGUE CASTLE



## Prague Castle Complex

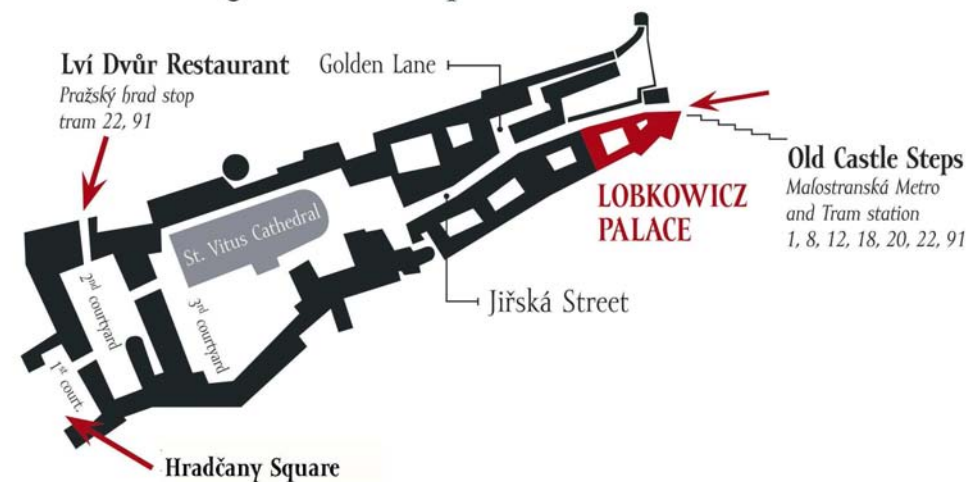

ADDRESS:

Lobkowitz Palace – Prague Castle

Jiřská 3

119 00, Prague 1



# LOBKOWICZ

LOBKOWICZ EVENTS MANAGEMENT



*Unique & Extraordinary.*